

PRESENTATION - PRÉSENTATION - ANSICHT

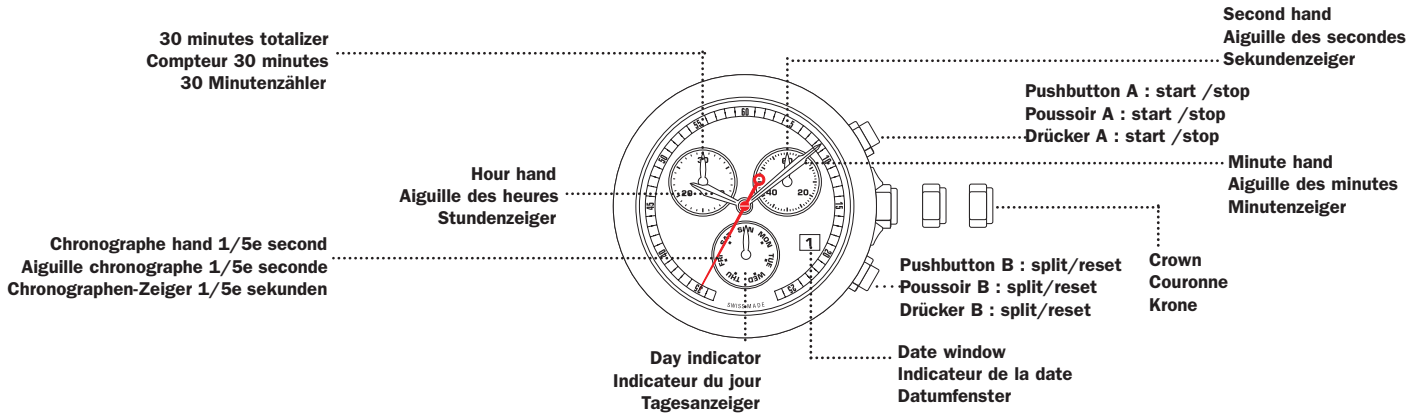

SETTINGS -- REGLAGES -- EINSTELLUNG

**SETTING THE TIME
HOUR AND MINUTE**

**REGLAGE DE L'HEURE
ET MINUTE**

**EINSTELLEN DER ZEITANZEIGE
STUNDEN UND MINUTEN**

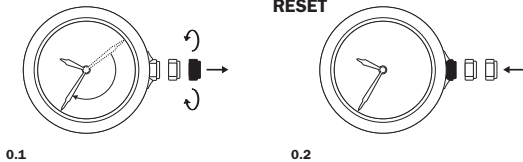

TO CORRECT THE DAY

CORRECTION DU JOUR

EINSTELLEN DES TAGES

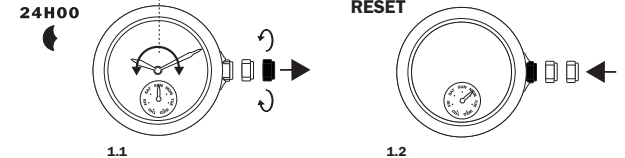

**SETTING THE DATE
CAUTION: NEVER CORRECT DATE
BETWEEN 9 PM AND 0.30 AM.**

**CORRECTION DE LA DATE
ATTENTION: LA CORRECTION
DE LA DATE NE PEUT PAS
SE FAIRE ENTRE 21H00 ET 0H30.**

**EINSTELLEN DES DATUMS
ACHTUNG: DATUM NICHT
ZWISCHEN 21 UHR UND
0 UHR 30 EINSTELLEN.**

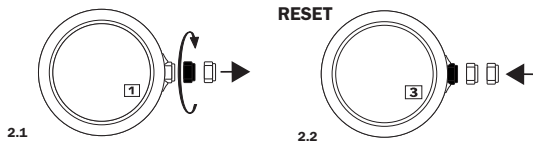

FUNCTIONS -- FONCTIONS -- FUNKTIONEN

MEASURING CUMULATIVE TIMES

MESURE DE TEMPS CUMULÉS

MESSUNG DER KUMULIERTEN ZEIT

AFTER 2 HOURS OF CONTINUOUS RUNNING, THE CHRONO STOPS AND RESETS AUTOMATICALLY TO SAVE THE BATTERY

APRÈS 2 HEURES DE MARCHE, LE CHRONO S'ARRÊTE ET SE REMET À ZÉRO AUTOMATIQUÉMENT AFIN D'ÉCONOMISER LA PILE.

NACH 2 LAUFSTUNDEN STOPPT DER CHRONO UND GEHT AUTOMATISCH AUF DIE NULLSTELLUNG ZURÜCK, UM DIE BATTERIESTROM ZU SPAREN

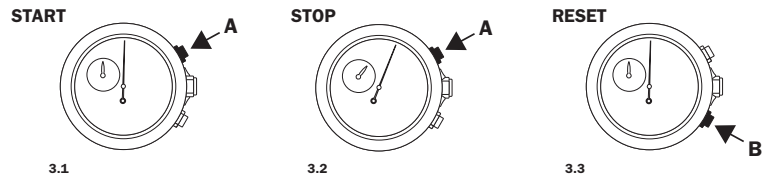

MEASURING SPLIT TIMES

MESURE DE TEMPS INTERMÉDIAIRES

MESSUNG VON ZWISCHENZEITEN

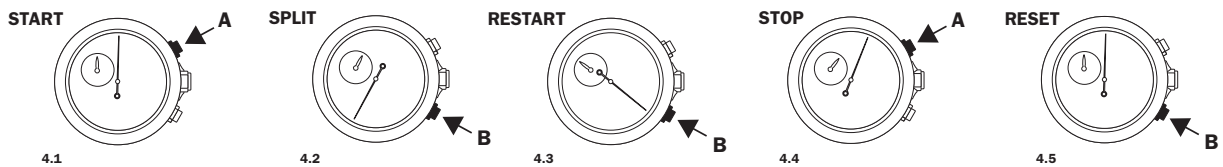

**AFTER BATTERY EXCHANGE
OR MISHANDLING ONLY**

**SEULEMENT APRÈS CHANGEMENT DE
LA PILE OU MAUVAISE MANIPULATION**

**NUR NACH BATTERIEWECHSEL
ODER UNKORREKTER HANDHABUNG**

TO RESET CHRONOGRAPH,
MINUTE AND SECOND CHRONOGRAPH

INITIALISATION CHRONOGRAPHE,
MINUTE ET SECONDE CHRONOGRAPHE

INITIALISIEREN DES CHRONOGRAPHE,
MINUTEN UND SEKUNDEN, CHRONOGRAPHE

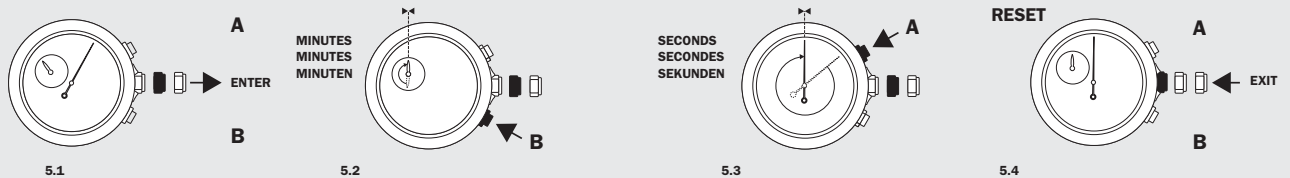

CALIBRATION -- INITIALISATION
EICHEN

PRESENTATION – PRESENTAZIONE – PRESENTACION

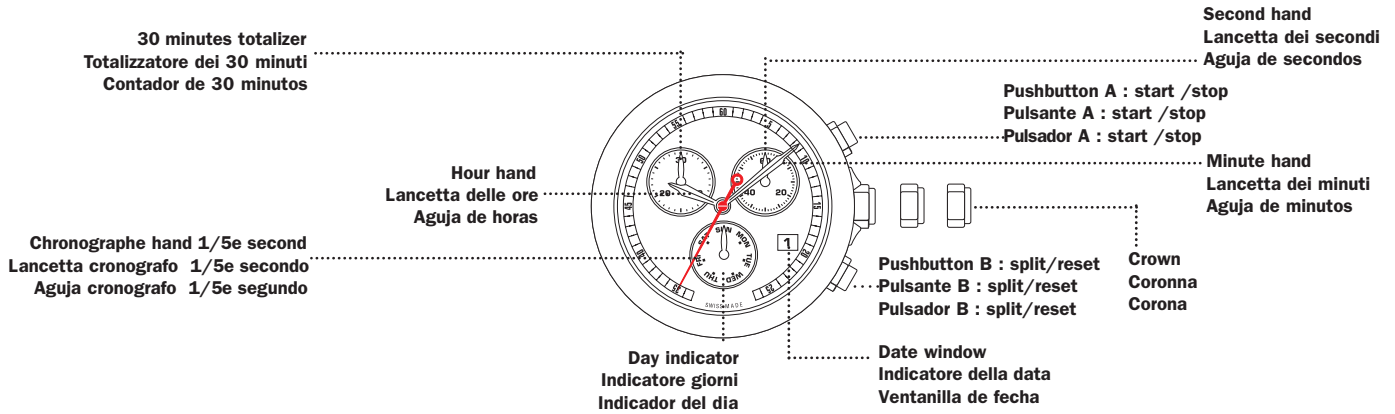

SETTINGS – CORREZIONE – AJUSTAR

SETTING THE TIME
HOUR AND MINUTE

CORREZIONE DELL'ORA
E MINUTI

AJUSTE HORA Y
MINUTO

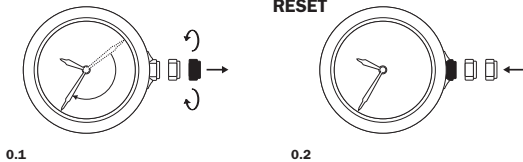

TO CORRECT THE DAY

CORREZIONE DEL GIORNO

AJUSTE DEL DIA

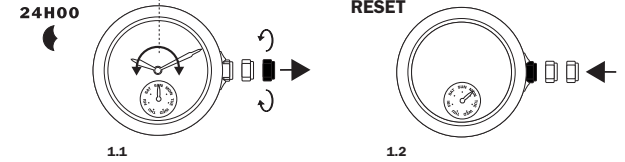

SETTING THE DATE
CAUTION: NEVER CORRECT DATE
BETWEEN 9 PM AND 0.30 AM.

CORREZIONE DELLA DATA
ATTENZIONE: IL CAMBIO DI
DATA NON È POSSIBILE DALLE
ORE 21 ALLE ORE 0.30.

AJUSTE DE LA FECHA
ATTENCION: CAMBIAR LA
FECHA NO SE PUEDE HACER
DENTRO LAS 21H Y 0H30.

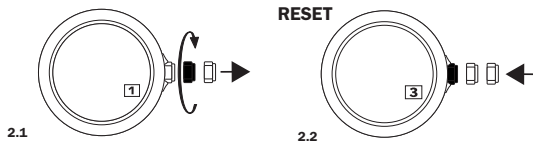

FUNCTIONS – FUNZIONE – FUNCIONES

MEASURING CUMULATIVE TIMES

MISURAZIONE DEI TEMPI CUMULATI

MEDIDAS DE TIEMPOS ACCUMULADOS

AFTER 2 HOURS OF CONTINUOUS RUNNING, THE CHRONO STOPS AND RESETS AUTOMATICALLY TO SAVE THE BATTERY
DOPO 2 ORE DI FUNZIONAMENTO IL CRONOGRIFO SI FERMA E TORNA A ZERO IN MODO DI RISPARMIARE LA BATTERIA.
DESPUES 2 HORAS DE FUNCIONAMIENTO EL CRONO SE INTERRUMPIE Y SE PONE A CERO AUTOMATICAMENTE PARA ECONOMISAR LA PILA.

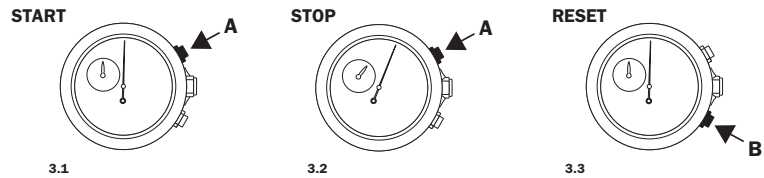

MEASURING SPLIT TIMES

MISURAZIONE DEI TEMPI INTERMEDIARI

MEDIDA DE TIEMPOS INTERMEDIARIOS

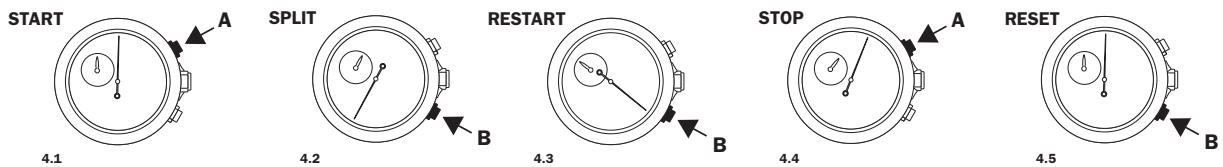

CALIBRATION – INIZIALIZAZIONE
INICIALIZACION

AFTER BATTERY EXCHANGE
OR MISHANDLING ONLY

SOLAMENTE DOPO CAMBIO DELLA
PILA O UTILIZZAZIONE ERRATA

SOLAMENTE DESPUES DE CAMBIAR
LA PILA O MALA MANIPULACION

TO RESET CHRONOGRAPH,
MINUTE AND SECOND CHRONOGRAPH

INIZIALIZAZIONE DEI CRONOGRIFO,
MINUTI SECONDI CRONOGRIFO

INICIALIZACION DEL CRONOGRIFO,
MINUTOS Y SEGUNDOS CRONOGRIFO

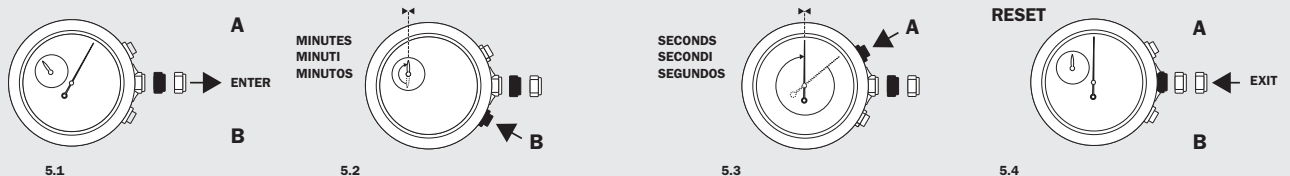

INFO

BATTERY - PILA
395 - SR 57

SERVICE LIFE BATTERY: WITHOUT CHRONO = 57 MONTHS, WITH CHRONO 1H/D = 41 MONTHS
AUTONOMIA DELLA PILA: SENZA CRONO = 57 MESI, CON CRONOORA/G = 41 MESI
DURACION DE LA PILA: SIN CHRONO = 57 MESES, CON CHRONO/D = 41 MESES